



HODEDAH

www.hodedah.com

support@hodedah.com

ASSEMBLY INSTRUCTIONS

METAL BED

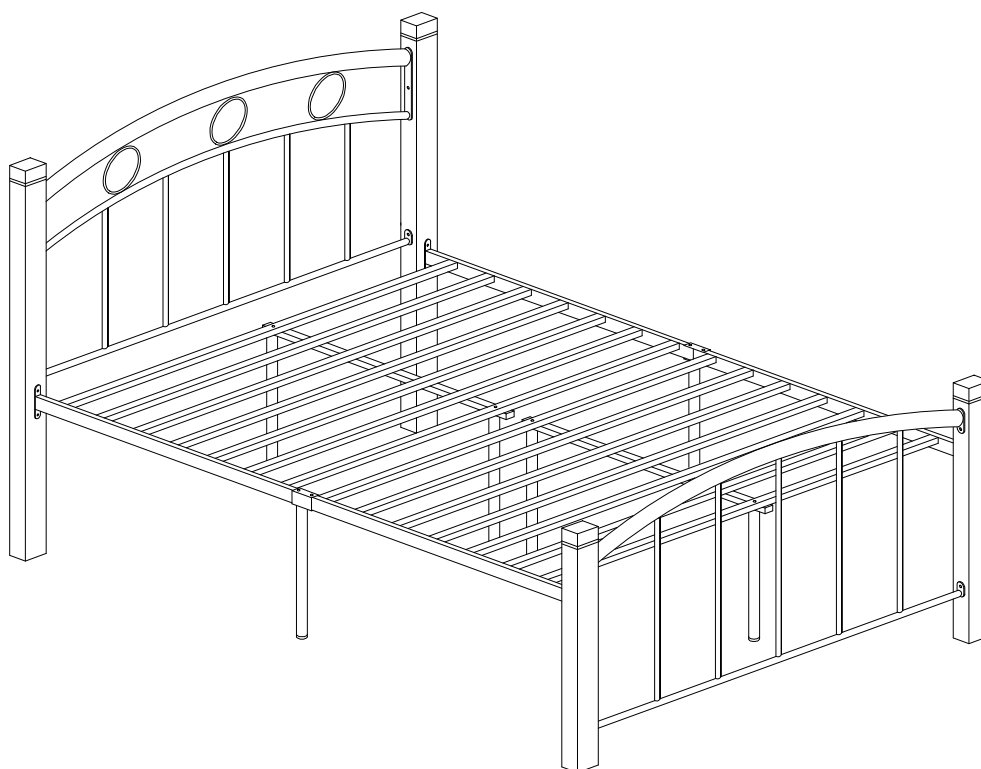

HI 599 TWIN



HODEDAH

www.hodedah.com

support@hodedah.com



IMPORTANT NOTE :

- *This product contains small components, please ensure that they are kept away from small children.*
- *This instruction booklet contains **IMPORTANT** safety information. Please read and keep for future reference.*
- *Note : you will find extra screws and bolts in hardware pack in case of any missing pieces.*
- *If the glass is chipped or broken, do not attempt to assemble the item.*

DO NOT RETURN PRODUCT TO THE STORE



*If a part is missing or damaged, email our customer service. We will gladly ship your replacement parts **FREE** of charges.*

Need Parts or Assistance ?

Email us at

support@hodedah.com

For prompt, reliable service, please have your assembly manual ready.



HODEDAH

www.hodedah.com

support@hodedah.com

Thank you for purchasing from Hodedah

**To learn more about Hodedah and our products visit
www.hodedah.com**

READ BEFORE BEGINING ASSEMBLY

- Read each step carefully. It is very important that each step of instruction is performed in the correct order. If these steps are not followed in sequence, assembly difficulties will occur.
- Make sure all parts are included. Most parts are labeled or stamped on the raw edge.
- Work in spaciuous area, preferably on a carpet, near the placethe unit will be used.
- Do not use power tool assemble your future. Power tools may strip or damage the parts.

HELPFUL HINTS

- Call us if you need assistance.
- Move your new furniture carefully, with two people lift and carry the nuit to it's new location.
- Never push, drag or pull your furniture (especially on carpet).

Warranty Information

Hodedah warrants this product to be free defect in material and workmanship agrees to remedy any such defect. This warranty covers one year from the date of original purchase. This is solely limited to be repair or replacement of defective parts and no assembly labor is included.

This warranty does not apply to any product which has been improperly assembled, subjected to misuse or abuse or which has been altered or repaired in any way.

To obtain warranty service, purchaser must present original bill of sale. Compenents repaired or replaced throught the remainder of the original warranty period only. The defective compenents will be repaired or replaced without charge, subject to the terms and conditions described above.

**For help with assembly, Identifying parts, product information
or to order parts, please contact us :**

Call us at :

718-456-0505

Monday-Friday

9.00 a.m-5.00 p.m

Visit our website :

www.hodedah.com



HODEDAH

www.hodedah.com

support@hodedah.com

Breakdown Structure

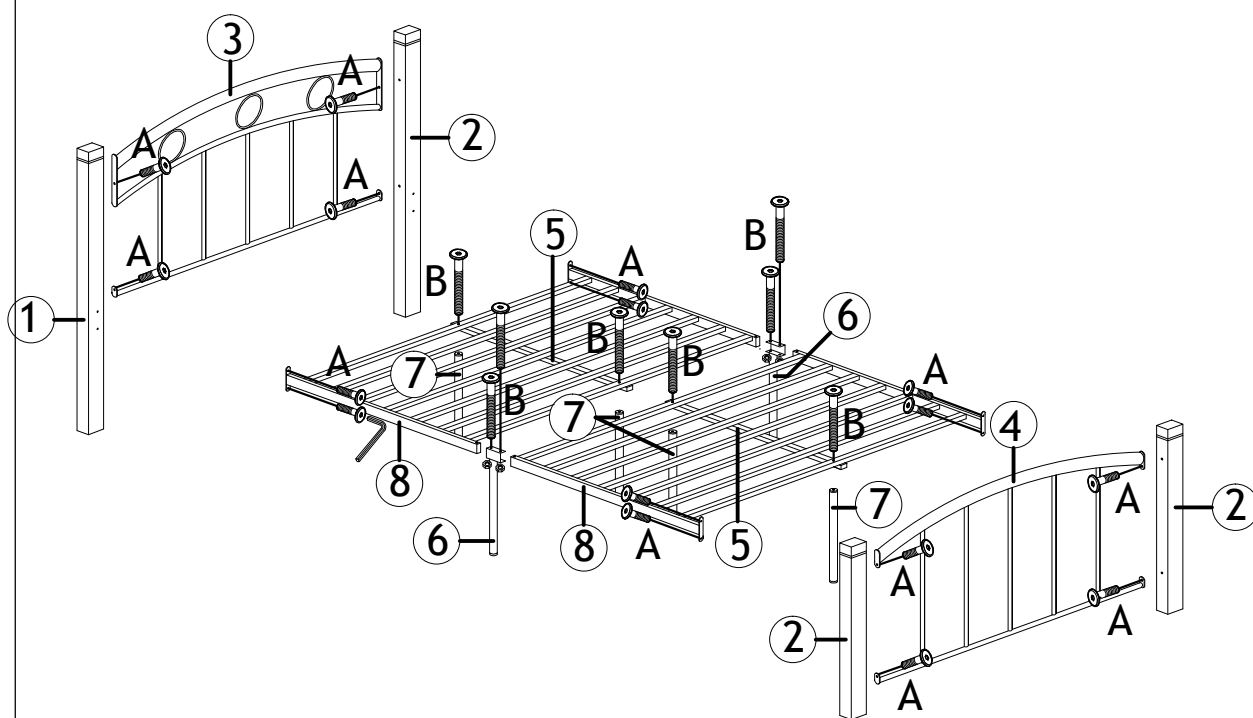



HODEDAH

www.hodedah.com

support@hodedah.com

Parts

① Head Post



2 un.

② Foot Post



2 un.

③ Head Board

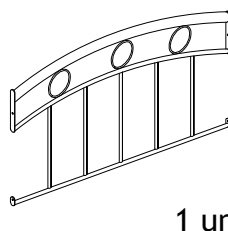

1 un.

④ Foot Board

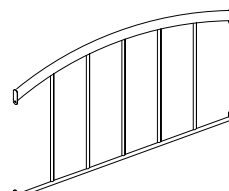

1 un.

⑤ Center Rail



2 un.

⑥ Side Support Legs



2 un.

⑦ Center Support Legs



4 un.

⑧ Bed Sheet

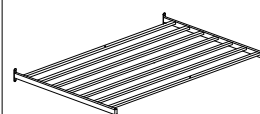

2 un.

Hardware

Ⓐ M6 x 20mm Jcbb Screw x 8 Pcs

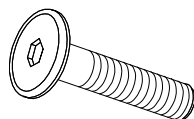

Ⓑ M6 X 65mm Jcbc Screw X 8 Pcs

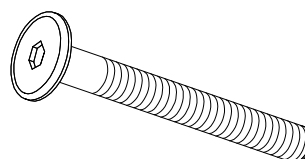

Ⓒ M6 Hex Nuts x 4 Pcs

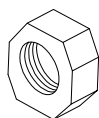

Ⓓ M4 Allen Key x 1 Pc

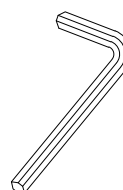



HODEDAH

www.hodedah.com

support@hodedah.com

Step 3

Connect #② Foot Post to ④ Footboard using letter ① screws from the inner FB to post using ③ Allen Key.

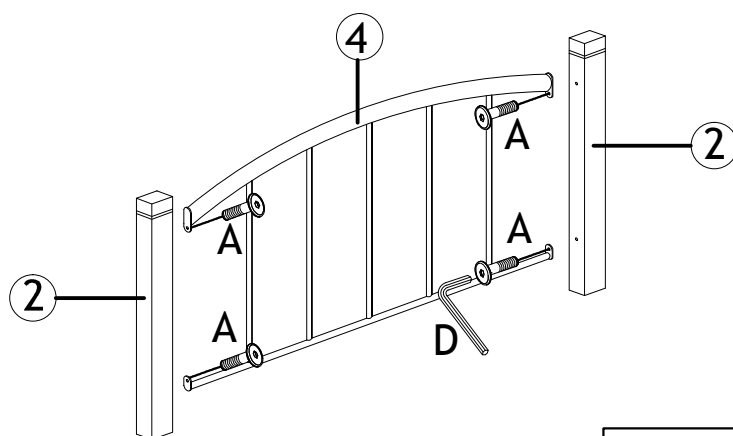

HARDWARE REQUIRED



4*A

1*D

Step 4

Take #⑧ Bed Sheet. Align it to ② Post using ① Screw and ③ Allen Key.

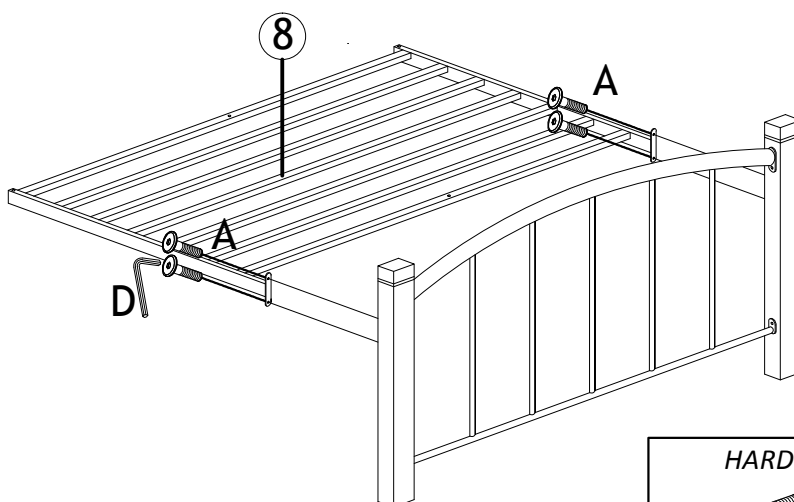

HARDWARE REQUIRED



4*A



1*D



HODEDAH

www.hodedah.com

support@hodedah.com

Step 1

Connect #③ HB to # 1 Head Post by using letter ① screws from inner Head Board to connect to ① Post using ② Allen Key.

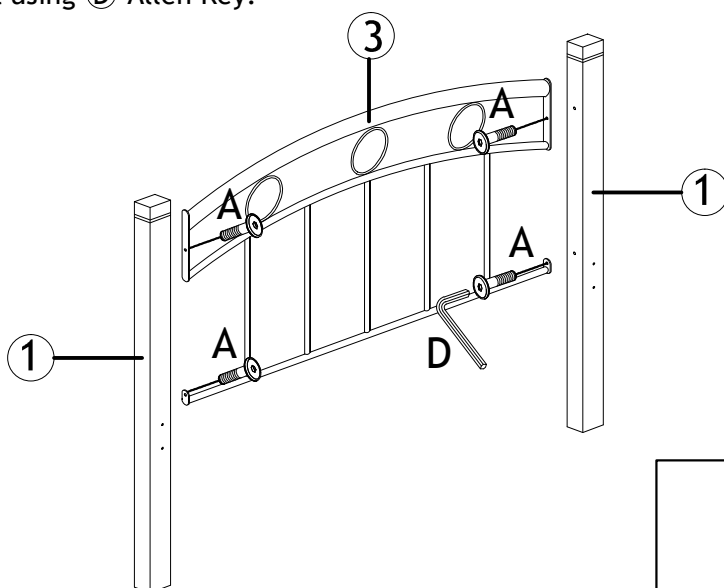

HARDWARE REQUIRED



4*A



1*D

Step 2

Take #⑧ and align it to Head Post #① using ① screws and ② Allen Key.

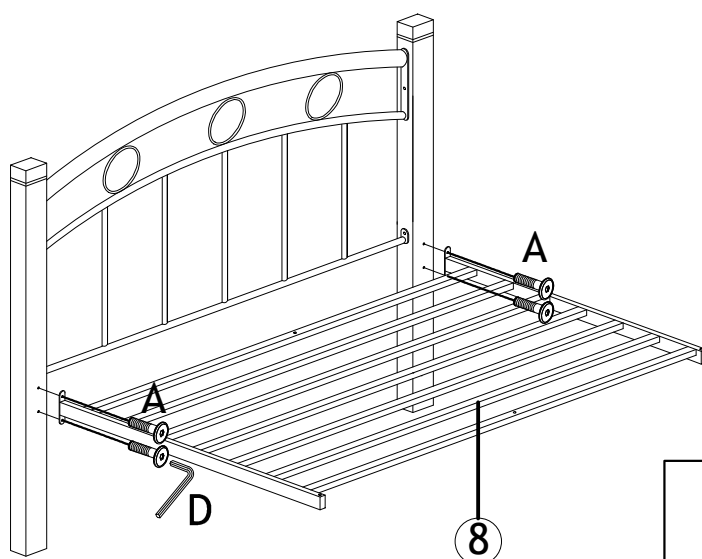

HARDWARE REQUIRED



4*A



1*D



HODEDAH

www.hodedah.com

support@hodedah.com

Step 5

Take the Center Rail ⑤ insert under the ⑧ Bed Sheet then using the Qty of 4 Support legs ⑦ using Screw ③ and Allen Key ④.

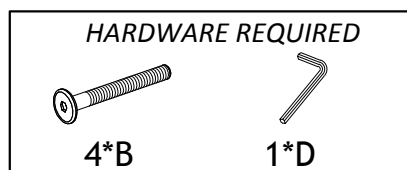
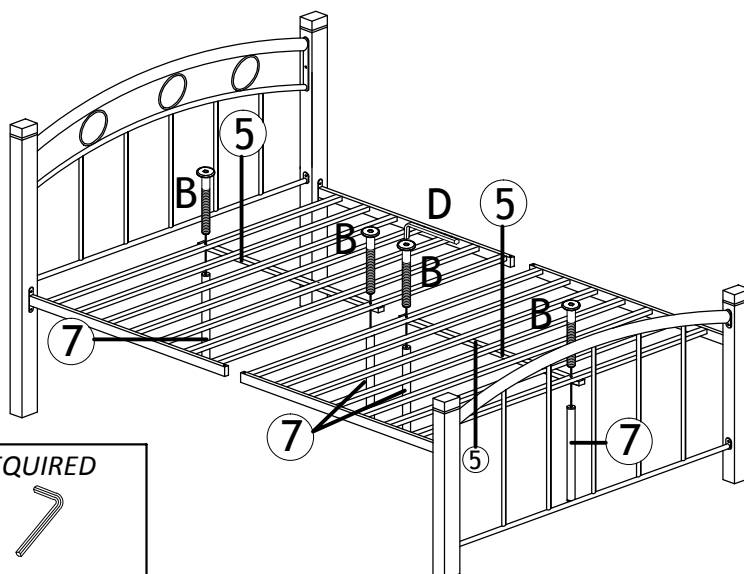

Step 6

Take the Side Support Legs ⑥. Place it on the Side of Bed Sheets ⑧. Insert ③ Screws from top of Bed Sheet using ④ AllenKey and inrock ⑤ Nuts on the bottom.

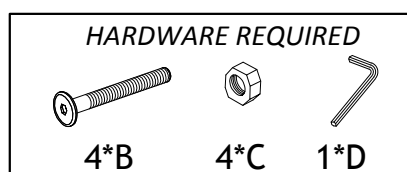
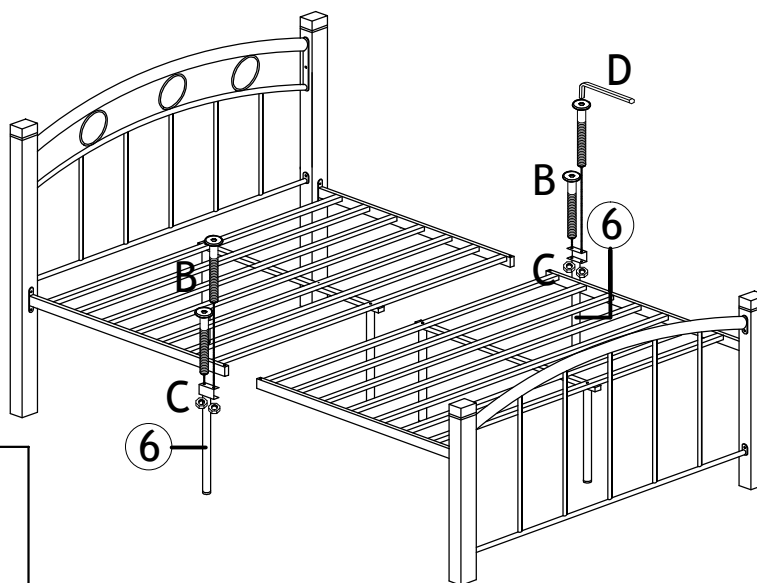



HODEDAH

www.hodedah.com

support@hodedah.com

Step 7

. Tighten all bolts with allen key (D) after making sure they are in the right position.

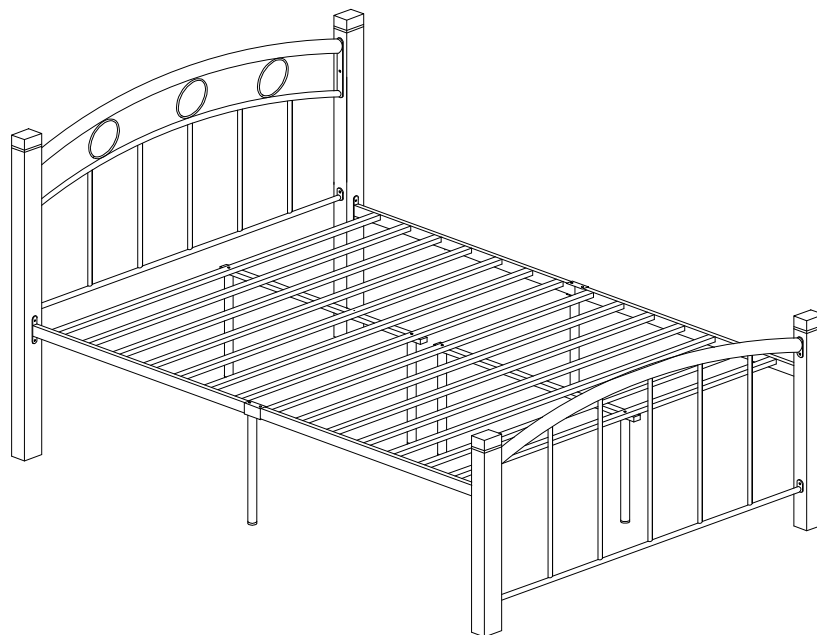

Job Complete !

In the interest of our environment please dispose of all packaging thoughtfully.